

ER 28 - 18 pinos

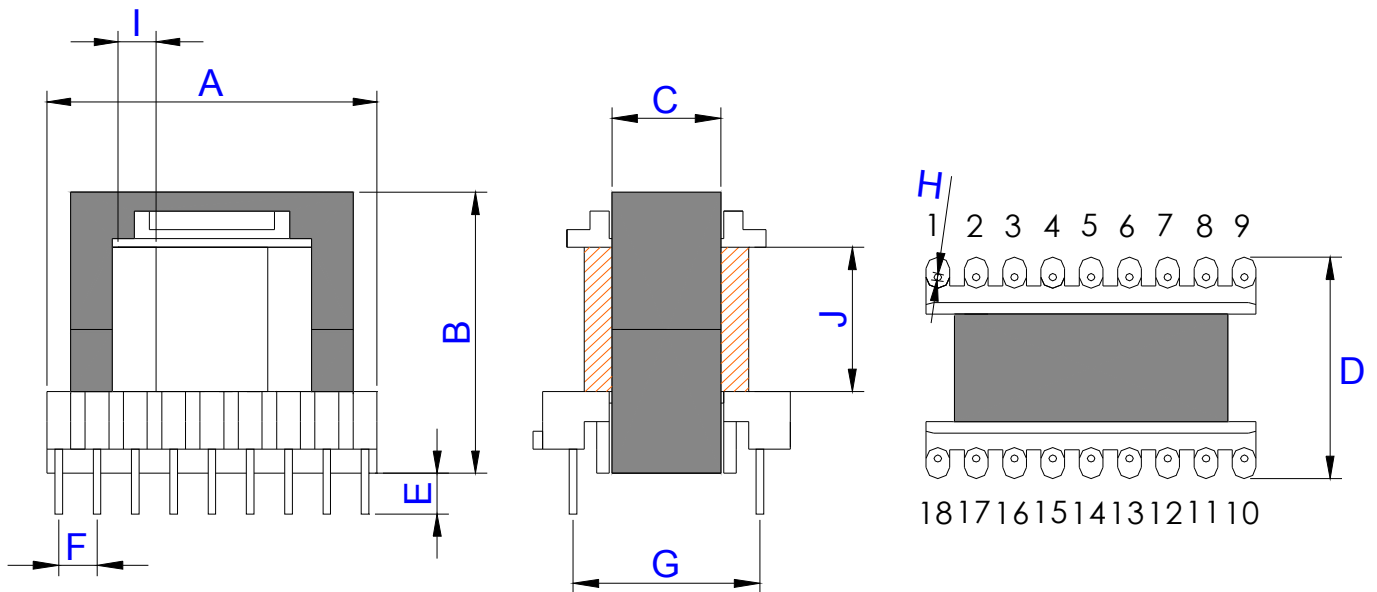

TOLERÂNCIA: +/- 0,5mm.

ÁREA ÚTIL DA JANELA: 53,4mm²

CARRETEL	A	B	C	D	E	F	G	H	I	J
ER 28 - 18 pinos	34,6	35,2	9,8	23,8	4,0	4,0	20,0	1,0	4,5	19,8